

RECORD OF SURVEY NO. 34-31

A LOT LINE ADJUSTMENT OF LOTS 3 & 4, BLOCK 2, MB 1/11, SILVER LAKE PINES TRACT NO. 5 AND PARCEL 1, PMB 2/84, LOCATED IN THE N1/2, SEC 21, T2S, R2GE, MDB&M, MONO COUNTY, CALIFORNIA.

SURVEYOR'S STATEMENT

THIS MAP CORRECTLY REPRESENTS A SURVEY MADE BY ME OR UNDER MY DIRECTION IN CONFORMANCE WITH THE REQUIREMENTS OF THE LAND SURVEYOR'S ACT AT THE REQUEST OF LOUIS NOTHWANG IN JUNE, OF 1989.

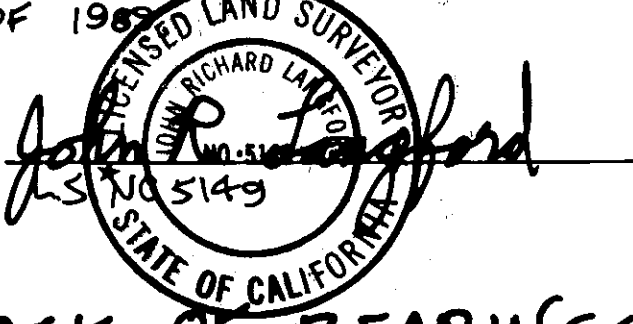

COUNTY SURVEYOR'S STATEMENT

THIS MAP HAS BEEN EXAMINED IN ACCORDANCE WITH SECTION 8766 OF THE LAND SURVEYOR'S ACT THIS 11 DAY OF December, 1989.

James M. Ward
COUNTY SURVEYOR



COUNTY RECORDER'S CERTIFICATE

FILED THIS 12th DAY OF December, 1989, AT 10:35 A.M. IN BOOK RS 2 OF RECORD OF SURVEYS AT PAGE 65 AT THE REQUEST OF LOUIS NOTHWANG.

INSTRUMENT NO. #3898

FEE: \$5.00

RENN NOLAN

MONO COUNTY

RECORDER BY: *Ren M. Miller*
DEPUTY COUNTY RECORDER

BASIS OF BEARINGS:

50°20'56"W, THE EAST LINE OF SILVER LAKE PINES TRACT NO. 5 PER RSMB 2/25.

LEGEND:

- FND 1" I.D.I.P. & TAG RCE 10467 PER PMB 2/84 UNLESS OTHERWISE NOTED.
- SET 1 1/2" DIAM. ALUM CAP STAMPED LS 5149 ON 5/8" DIAM REBAR.
- r BASED ON RECORD INFORMATION AS NOTED.
- m BASED ON FIELD MEASUREMENTS

SCALE: 1" = 20'

