

CORNER RECORD

COUNTY OF: ~~INYO~~ MONO T. 6 N. R. 23 E MDB MERIDIAN CALIFORNIA
 CORNER TYPE: GOV'T. CORNER ☒ MEANDER ☐ RANCHO ☐ CONTROL ☐ OTHER ☐
 CORNER IDENTIFICATION - DATE OF VISIT October 21, 1983

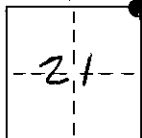

CORNER - LEFT AS FOUND ☐ FOUND AND TAGGED ☐ REESTABLISHED OBLITERATED CORNER ☐ REBUILT ☐

PHYSICAL DESCRIPTION OF CORNER FOUND: EVIDENCE AND METHOD USED TO IDENTIFY OR REESTABLISH Ind. 1 1/2" I.P.
(OD) with RCE #27104 tag in ctr. of old mound of stone. A old 3.5' high
metal post projects out of mound. Located 10± west of a barbed wire fence,
85± north of the crest of a sage covered ridge and 1150± west of State
Highway 395.

PHYSICAL DESCRIPTION OF MONUMENTS REBUILT OR PERPETUATED

CALIFORNIA COORDINATE SYSTEM ORDER: FIRST ☐ SECOND ☐ THIRD ☐

STATIONS USED: NGS (USC & GS) ☐ STATE ☐ COUNTY ☐ OTHER ☐ STATION STATION

ZONE ELEVATION NORTHINGS (Y) EASTINGS (X)

SKETCH: (Include reference tie or witness points, remarks and topo of area)

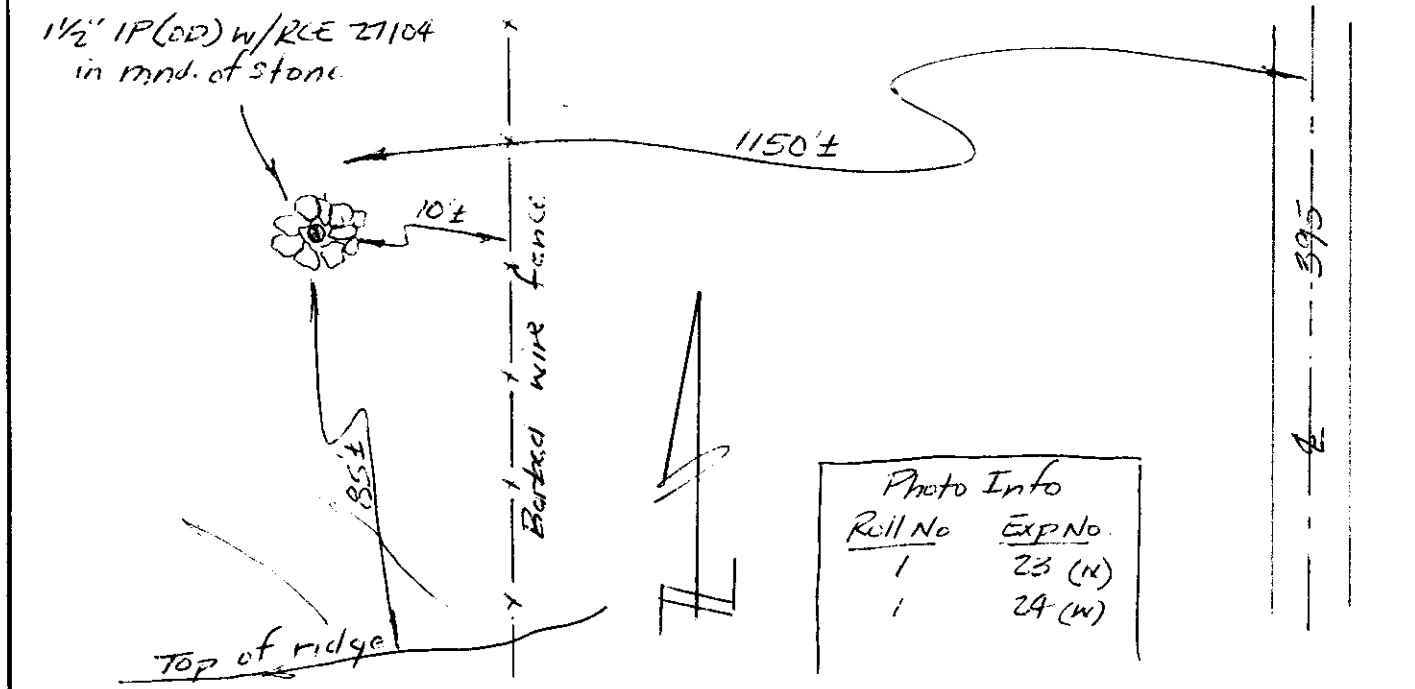

SURVEYOR'S CERTIFICATE

THIS CORNER RECORD WAS PREPARED BY ME OR UNDER MY
 DIRECTION IN CONFORMANCE WITH THE LAND SURVEYORS ACT
 ON October 21, 1983

SIGNED: R. L. Clark

L.S. or R.C.E. No.: Chief of Party - Cultran

SEAL

COUNTY SURVEYOR'S CERTIFICATE

THIS CORNER RECORD WAS RECEIVED 11-29-83
 AND EXAMINED AND FILED 12-16-83

BY: Rich. R. Roodman

TITLE: Deputy County Surveyor

DOCUMENT No. 6N-23-21-5

STATEMENT ON BACK OF SHEET

YES ☒ NO ☐