

BASIS OF BEARINGS
 Bearings, distances and coordinates are based on the California Coordinate System, Zone 3. Distances are ground distances. To obtain grid distances, multiply ground distances by 0.99995. (See found monuments on this sheet)

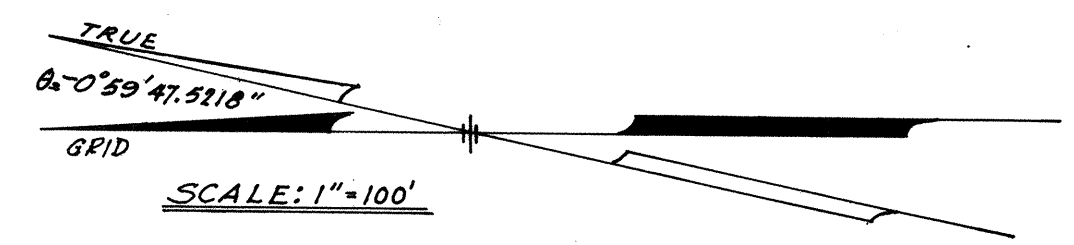

PARCEL MAP NO. 2360
Being a Resubdivision of Lot 4 of "TRACT 3640"
Recorded July 22, 1977 Book 96 of Tract Maps at Pages 13-16
CROCKER-HAYWARD (NORTH)
INDUSTRIAL PARK
 SCALE: 1"=100'
 SEPTEMBER, 1977
 Donald N. Hohl - Civil Engineer - Crocker Land Company - 660 Mkt St., San Francisco
 CITY OF HAYWARD - ALAMEDA COUNTY - CALIFORNIA
 #78-9541
 Sheet 2 of 2 Sheets
 101/14